

G-2150 / S-2150

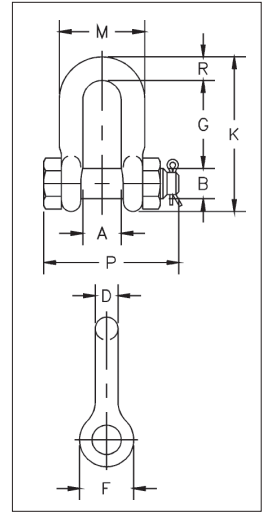

- Working Load Limit and Grade 6 permanently shown on every shackle.
- Forged, Quenched & Tempered, with alloy pins.
- Hot-dip galvanized (G) or self-colored (S). 85 ton shackles have hot-dip galvanized bows and the bolts are Dimetcoated® and painted red.
- Sizes 3/8 inch and below are mechanically galvanized.
- Fatigue rated to 20,000 cycles at 1-1/2 times the Working Load Limit. (1/2t - 55t).
- Approved for use at -40° F (-40° C) to 400° F (204° C).
- Meets or exceeds all requirements of ASME B30.26.
- Sizes 1/2 - 25t meet the performance requirements of EN13889:2003.
- Shackles 55 metric tons and smaller can be furnished proof tested with certificates to designated standards, such as ABS, DNV, Lloyds, or other certification when requested at time of order.
- Type Approval certification in accordance with ABS 2016 Steel Vessel Rules and 2016 ABS Guide for Certification of Lifting Appliance. Certificates available when requested at time of order and may include additional charges.
- Meets the performance requirements of Federal Specification RR-C-271G, Type IVB, Grade A, Class 3, except for those provisions required of the contractor.
- All 2150 shackles can meet charpy requirements of 31 ft-lb (42 Joules) avg at -4° F (-20° C) upon special request.
- Look for the Red Pin®... the mark of genuine Crosby quality.



G-2150 / S-2150 Bolt Type Chain Shackles

Nominal Size (in)	Working Load Limit (t)*	Stock No.		Weight Each (lb)	Dimensions (in)										Tolerance (+ / - in)	
		G-2150	S-2150		A	B	D	F	G	K	M	P	R	G	A	
1/4	0.5	1019768	-	.13	.47	.31	.25	.62	.91	1.59	.97	1.56	.25	.06	.06	
5/16	0.75	1019770	-	.23	.53	.38	.31	.75	1.07	1.91	1.15	1.82	.31	.06	.06	
3/8	1	1019772	-	.33	.66	.44	.38	.92	1.28	2.31	1.42	2.17	.38	.13	.06	
7/16	1.5	1019774	-	.49	.75	.50	.44	1.06	1.48	2.67	1.63	2.51	.44	.13	.06	
1/2	2	1019775	1019784	.75	.81	.64	.50	1.18	1.66	3.03	1.81	2.80	.50	.13	.06	
5/8	3.25	1019793	1019800	1.47	1.06	.77	.63	1.50	2.04	3.76	2.32	3.56	.63	.13	.06	
3/4	4.75	1019819	1019828	2.52	1.25	.89	.75	1.81	2.40	4.53	2.75	4.15	.81	.25	.06	
7/8	6.5	1019837	1019846	3.85	1.44	1.02	.88	2.10	2.86	5.33	3.20	4.82	.97	.25	.06	
1	8.5	1019855	1019864	5.55	1.69	1.15	1.00	2.38	3.24	5.94	3.69	5.39	1.00	.25	.06	
1-1/8	9.5	1019873	1019882	7.60	1.81	1.25	1.13	2.68	3.61	6.78	4.07	5.90	1.25	.25	.06	
1-1/4	12	1019891	1019908	10.81	2.03	1.40	1.25	3.00	3.97	7.50	4.53	6.69	1.38	.25	.06	
1-3/8	13.5	1019917	1019926	13.75	2.25	1.53	1.38	3.31	4.43	8.28	5.01	7.21	1.50	.25	.13	
1-1/2	17	1019935	1019944	17.01	2.38	1.66	1.50	3.62	4.87	9.05	5.38	7.73	1.62	.25	.13	
1-3/4	25	1019953	1019962	31.40	2.88	2.04	1.75	4.19	5.82	10.97	6.38	9.33	2.12	.25	.13	
2	35	1019971	1019980	46.75	3.25	2.30	2.10	5.00	6.82	12.74	7.25	10.41	2.36	.25	.13	
2-1/2	55	1019999	1020004	85.00	4.12	2.80	2.63	5.68	8.07	14.85	9.38	13.58	2.63	.25	.25	
3	† 85	1020013	-	124.25	5.00	3.25	3.00	6.50	8.56	16.87	11.00	15.13	3.50	.25	.25	

6:1 Design Factor. Maximum Proof Load is 2 times the Working Load Limit. For Working Load Limit reduction due to side loading applications, see Warnings & Applications.
 † Individually Proof Tested with certification.

